

LEGAL DESCRIPTION  
 A TRACT OF LAND IN THE SOUTHWEST QUARTER AND THE NORTHWEST QUARTER OF SECTION 20, TOWNSHIP 22 S, RANGE 24 E LINN COUNTY, KANSAS, BEGINNING AT A POINT 18.22 FEET SOUTH AND 852.09 FEET EAST OF THE WEST QUARTER CORNER OF SECTION 20, THENCE S66°E 180.00 FEET, THENCE N24°E 70.00 FEET, THENCE S66°E 130.00 FEET, THENCE N24°E 75.00 FEET, THENCE N90°E 86.81 FEET, THENCE S0°E 23.57 FEET, THENCE S90°E 130.00 FEET, THENCE N0°E 78.69 FEET, THENCE N20°W 56.92 FEET, THENCE N80°E 304.47 FEET, THENCE S0°E 100.00 FEET, THENCE S90°E 310.00 FEET, THENCE S0°E 70.00 FEET, THENCE S90°E 50.00 FEET, THENCE N40°E 154.10 FEET, THENCE N10°W 126.43 FEET, THENCE N25°W 228.84 FEET, THENCE N15°W 490.61 FEET, THENCE N80°W 70.00 FEET, THENCE S63°W 194.01 FEET, THENCE S48°W 316.77 FEET, THENCE S34°W 143.31 FEET, THENCE S5°E 150.44 FEET, THENCE S30°E 213.76 FEET, THENCE N90°W 79.47 FEET, THENCE N20°W 136.07 FEET, THENCE S48°W 171.00 FEET, THENCE N80°W 71.00 FEET, THENCE S65°W 103.75 FEET, THENCE S37°W 201.04 FEET, THENCE S24°W 154.81 FEET TO THE POINT OF BEGINNING, SAID TRACT CONTAINING 14.01 ACRES.

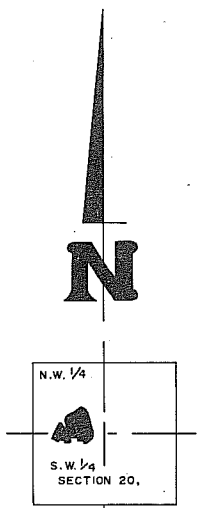

SECTION 20,  
 TOWNSHIP 22 S, RANGE 24 E.

**DEDICATION**

"SUGAR VALLEY LAKES, A KANSAS LIMITED PARTNERSHIP IN RECORDING THIS PLAT OF SUGAR VALLEY LAKES SUBDIVISION HAS DESIGNATED CERTAIN AREAS OF LAND AS ROADS, STREETS, DRIVEWAYS, PARKS, CAMPING GROUNDS AND LAKES INTENDED FOR USE BY THE LOT OWNERS IN SUGAR VALLEY LAKES SUBDIVISION FOR RECREATION AND OTHER RELATED ACTIVITIES.  
 THE ABOVE DESCRIBED AREAS ARE NOT DEDICATED HEREBY FOR USE BY THE GENERAL PUBLIC BUT ARE DEDICATED TO THE COMMON USE AND ENJOYMENT OF THE LOT OWNERS OF SUGAR VALLEY LAKES SUBDIVISION AS MORE FULLY PROVIDED IN ARTICLE V, DECLARATION OF COVENANTS AND RESTRICTIONS APPLICABLE TO SUGAR VALLEY LAKES SUBDIVISION, DATED APRIL 25, 1972 AND RECORDED WITH THIS PLAT. SAID ARTICLE V IS HEREBY INCORPORATED AND MADE A PART OF THIS PLAT."



**ACKNOWLEDGEMENT**

STATE OF KANSAS ) SS  
 COUNTY OF LINN )  
 ON THIS \_\_\_\_\_ DAY OF \_\_\_\_\_, 197\_\_\_\_, BEFORE ME A NOTARY PUBLIC IN AND FOR SAID COUNTY PERSONALLY APPEARED \_\_\_\_\_ TO ME KNOWN TO BE THE PERSON WHO EXECUTED FOREGOING INSTRUMENT AND ACKNOWLEDGE THAT THEY EXECUTED THE SAME FREE ACT AND DEED IN TESTIMONY WHEREOF I HAVE HEREUNTO SET MY HAND AND AFFIXED MY OFFICIAL SEAL AT MY OFFICE.  
 MY COMMISSION EXPIRES \_\_\_\_\_

A NOTARY IN AND FOR SAID COUNTY

**RECORDER CERTIFICATE**

STATE OF KANSAS ) SS  
 COUNTY OF LINN )  
 IN THE OFFICE OF RECORDER OF DEEDS, I RECORDER OF SAID COUNTY DO HEREBY CERTIFY THAT THE WITHIN INSTRUMENT OF WRITING AND PLAT WAS WITH CERTIFICATE THEREON AT \_\_\_\_\_ O'CLOCK AND \_\_\_\_\_ MINUTES \_\_\_\_\_ M. ON THE \_\_\_\_\_ DAY OF \_\_\_\_\_, 197\_\_\_\_, DULY FILED FOR RECORD IN THIS OFFICE IN PLAT BOOK \_\_\_\_\_ AT PAGE \_\_\_\_\_, IN WITNESS THEREOF I HAVE HEREUNTO SET MY HAND AND AFFIXED MY OFFICIAL SEAL AT \_\_\_\_\_, KANSAS, THIS \_\_\_\_\_ DAY OF \_\_\_\_\_, 197\_\_\_\_.

RECORDER  
 DEPUTY.

**SURVEYORS CERTIFICATE**

"I, WILLIAM J. JONAS, A REGISTERED LAND SURVEYOR OF KANSAS, DO HEREBY CERTIFY THAT THE SURVEYORS FIELD NOTES OF THE ATTACHED PLAT IS A TRUE AND ACCURATE DESCRIPTION OF THE WORK DONE AND MEASUREMENTS TAKEN IN THE FIELD FOR STAKING OF SAID PLAT. IN TESTIMONY WHEREOF I HAVE SET MY HAND AND SEAL THIS \_\_\_\_\_ DAY OF \_\_\_\_\_, 197\_\_\_\_.

WILLIAM J. JONAS L.S.-589

|                             |          |        |      |     |
|-----------------------------|----------|--------|------|-----|
| SUGAR VALLEY LAKES ADDITION |          |        |      |     |
| PLAT NO. 29                 |          |        |      |     |
| LINN COUNTY, KANSAS         |          |        |      |     |
| JONAS ENGINEERING CO.       |          |        |      |     |
| PLEASANTON, KANSAS          |          |        |      |     |
| SCALE                       | DATE     | DWN BY | CHK  | APP |
| 1"=50'                      | 11-17-73 | J.D.S. | C.A. | 22  |